



COPYRIGHT © CPM ENGINEERING
INFORMATION CONTAINED IN THIS DRAWING / FILE IS THE COPYRIGHT OF CPM ENGINEERING.
COPYING OR USING THIS DATA IN WHOLE OR PART, IN ANY FORMAT, WITHOUT PERMISSION
INFRINGES COPYRIGHT ©
THIS DOCUMENT IN BOTH ELECTRONIC AND HARD COPY FORMAT IS AND SHALL REMAIN THE
PROPERTY OF CPM ENGINEERING. THE INFORMATION MAY ONLY BE USED FOR THE
PURPOSE FOR WHICH IT WAS COMMISSIONED AND IN ACCORDANCE WITH THE TERMS OF
ENGAGEMENT FOR THE COMMISSION. UNAUTHORISED USE OF THIS INFORMATION IN ANY FORM
WHATSOEVER IS PROHIBITED.

ENGINEERING INSPECTIONS : 48hrs NOTICE IS REQUIRED

- THE CONTRACTOR IS TO BE AWARE OF THE **MANDATORY** INSPECTIONS REQUIRED BY THE DEVELOPMENT CONSENT (DA) UNDER THE ENVIRONMENTAL PLANNING & ASSESSMENT ACT. CHECK WITH THE PCA.
- THESE MAY INCLUDE : EXCAVATION, REINFORCEMENT PRIOR TO CONCRETE POURING, PIPES & PITS PRIOR TO BACKFILL, FRAMING PRIOR TO COVERING, FINAL INSPECTION AND OTHER FOR VARIOUS CERTIFICATIONS.

UNDERGROUND SERVICES SEARCH SHOULD BE UNDERTAKEN PRIOR TO ANY EXCAVATION TAKING PLACE UPON THE SITE.

- GENERAL**
- THESE DRAWINGS SHALL BE READ IN CONJUNCTION WITH ALL ARCHITECTURAL, AND CONSULTANT DRAWINGS AND SPECIFICATIONS, THE DEVELOPMENT CONSENT / RELEVANT APPROVALS, AND OTHER WRITTEN INSTRUCTIONS THAT MAY BE ISSUED. THE CONTRACTOR IS TO MAKE THEMSELVES AWARE OF ALL SUCH DOCUMENTS.
 - DIMENSIONS SHALL NOT BE OBTAINED BY SCALING FROM THE DRAWINGS. REFER ARCHITECTS DRAWINGS FOR ALL DIMENSIONS.
 - REFER ANY DISCREPANCY TO THE ENGINEER/ARCHITECT.
 - MATERIALS AND WORKMANSHIP SHALL COMPLY WITH THE APPROPRIATE AUSTRALIAN STANDARDS, SPECIFICATIONS OR CODES AND WITH THE REQUIREMENTS OF THE RELEVANT LOCAL AUTHORITY.
 - THE ALIGNMENT AND LEVEL OF ALL SERVICES SHOWN ARE APPROXIMATE ONLY. THE CONTRACTOR SHALL CONFIRM THE POSITION AND LEVEL OF ALL SERVICES PRIOR TO COMMENCEMENT OF CONSTRUCTION. ANY DAMAGE TO SERVICES SHALL BE RECTIFIED AT THE CONTRACTORS EXPENSE.
 - ALL SERVICES, OR CONDUITS FOR SERVICING AND DRAINAGE SHALL BE INSTALLED PRIOR TO COMMENCEMENT OF PAVEMENT CONSTRUCTION.
 - DRAINAGE SHALL BE CONSTRUCTED IN ACCORDANCE WITH THE RELEVANT LOCAL AUTHORITY CONSTRUCTION SPECIFICATION AND THE CIVIL DRAWINGS.
 - NO WORK IS PERMITTED WITHIN ADJOINING PROPERTIES WITHOUT WRITTEN PERMISSION FROM THE OWNERS OR RESPONSIBLE AUTHORITY.
 - CONCRETE WORKS SHALL BE AS DETAILED ON THE DRAWINGS WITH REFERENCE TO THE CONCRETE SPECIFICATION.

- DRAINAGE**
- ALL DRAINAGE OUTLET PIPES / LEVELS SHALL BE CONFIRMED ON SITE, PRIOR TO CONSTRUCTION COMMENCING.
 - STORMWATER DRAINAGE SHALL BE GENERALLY IN ACCORDANCE WITH AS3500.3. PIPES OF 300mm DIA. AND SMALLER SHALL BE UPVC TO AS3254. PIPES OF 375mm DIA. AND LARGER SHALL BE FRC OR CONCRETE CLASS 2 TO AS1342 RUBBER RING JOINTED UNO.
 - ALL PIPES WITHIN THE PROPERTY TO BE MIN. 100 DIA UPVC @ 1% MIN. GRADE, UNO.
 - ALL PITS WITHIN THE PROPERTY ARE TO BE FITTED WITH "WELDLOK" OR APPROVED EQUIVALENT GRATES:
 - LIGHT DUTY FOR LANDSCAPED AREAS
 - HEAVY DUTY WHERE SUBJECTED TO VEHICULAR TRAFFIC
 - PITS WITHIN THE PROPERTY MAY BE CONSTRUCTED AS:
 - 1) PRECAST STORMWATER PITS
 - 2) CAST INSITU MASS CONCRETE
 - 3) ONLY 300 SQ. PITS IN LANDSCAPE AREAS CAN BE HDPE PLASTIC WHERE NOTED. SUBJECT TO THE RELEVANT LOCAL AUTHORITY CONSTRUCTION SPECIFICATION.
 - TRENCH DRAIN GRATES TO BE GALV. STEEL FRAME CAST INTO CONCRETE UNO.
 - PIPE / PIT BACKFILL TO BEDDING, HAUNCH AND OVERLAY ZONES IS TO BE 7₁₀ BLUE METAL, SANDY LOAM OR EQUIV. TAMP COMPACTED AT OPTIMUM MOISTURE, MAY VARY IN ROAD AREAS, IE SHARP CLEAN SAND, TO LOCAL AUTHORITY REQUIREMENTS.
 - MINIMUM PIPE COVER IS TYPICALLY 300mm AND 450mm IN ROADWAY AREAS.
 - ANY PIPES AT >16% GRADE REQUIRE CONCRETE BULKHEADS IN ACCORDANCE WITH AS 3500.3.2.
 - ENSURE ALL GRATES TO PITS ARE SET BELOW FINISHED SURFACE LEVEL WITHIN THE PROPERTY. TOP OF PIT RL'S ARE APPROXIMATE ONLY AND MAY BE VARIED SUBJECT TO APPROVAL OF THE ENGINEER. ALL INVERT LEVELS ARE TO BE ACHIEVED.
 - ALL PITS 600x900 AND LARGER ARE TO HAVE A 2.0m SUBSOIL LINE DRAINED INTO THE UPSTREAM FACE AT INVERT.
 - ALL PITS ARE TO HAVE CONCRETE BENCHING TO OUTLET INVERT AND UP TO THIRD HEIGHT PIPE DIAMETER UNLESS SUMP NOTED OTHERWISE.
 - THE CONTRACTOR IS TO BE AWARE OF THE OPENING TO DEPTH PIT REQUIREMENTS OF AS3500.3.2 IE:
 - 450SQ: 600 MAX. DEPTH
 - 600SQ: 900 MAX. DEPTH UNO.
 - PROVIDE STEP IRONS TO STORMWATER PITS GREATER THAN 1200 IN DEPTH.
 - SUBSOIL DRAINAGE SHALL BE PROVIDED TO ALL RETAINING WALLS & EMBANKMENTS, WITH THE LINES FEEDING INTO THE STORMWATER DRAINAGE SYSTEM.
 - ALL SERVICES TO BE LOCATED BY HAND DIGGING, BEFORE MECHANICAL EXCAVATION FOR THE SITE OUTLET

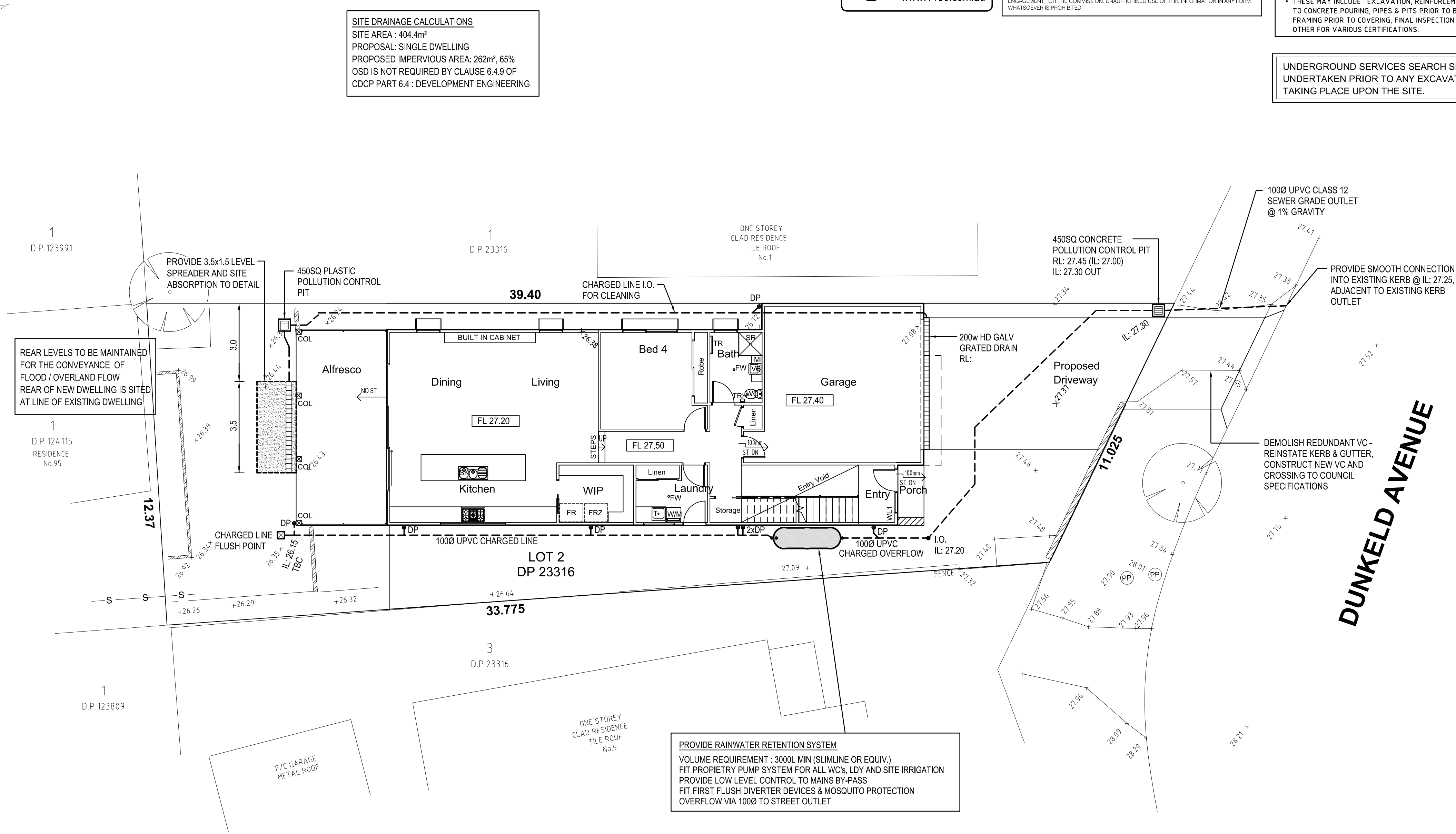

PLAN OF SITE DRAINAGE

1:100

LEGEND

- STORMWATER PIT
- DOWN PIPE
- EXISTING LEVEL
- PROPOSED LEVEL
- PROPOSED STORMWATER LINE

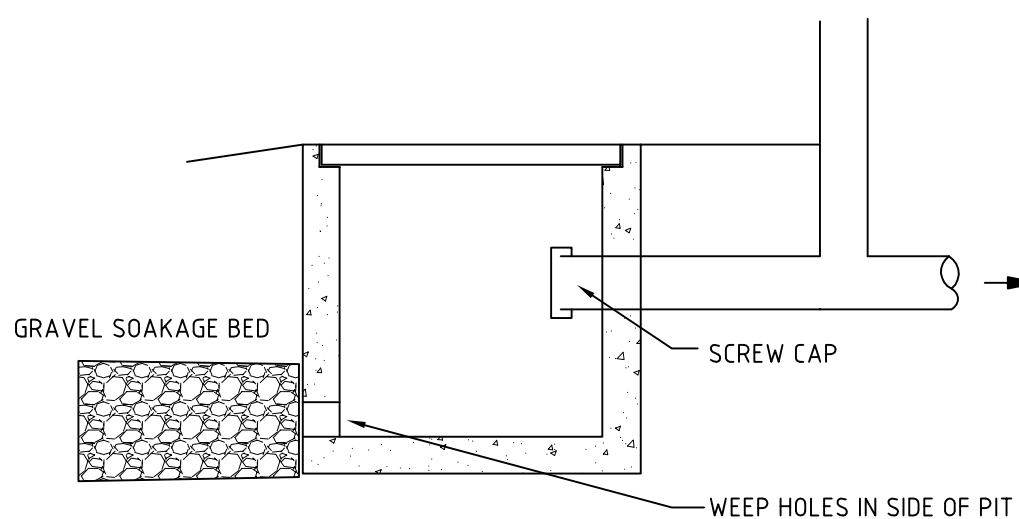

TYPICAL DETAIL OF CLEANING EYE PIT
NTS

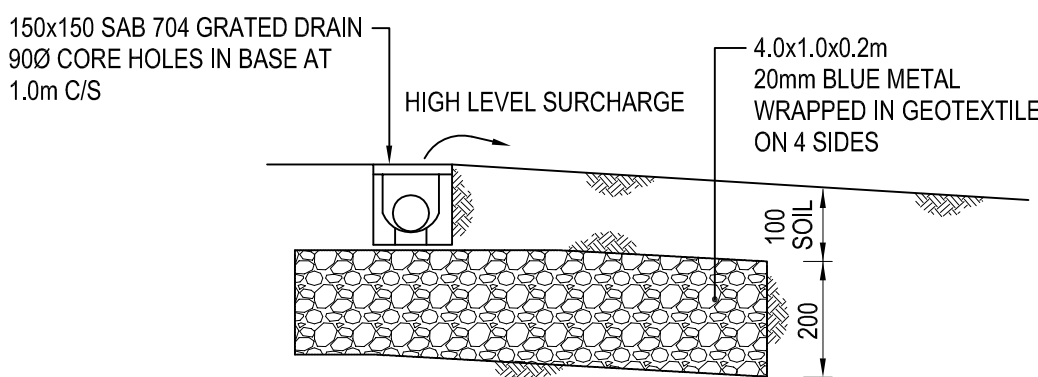

SECTION A : LEVEL SPREADER

1:20

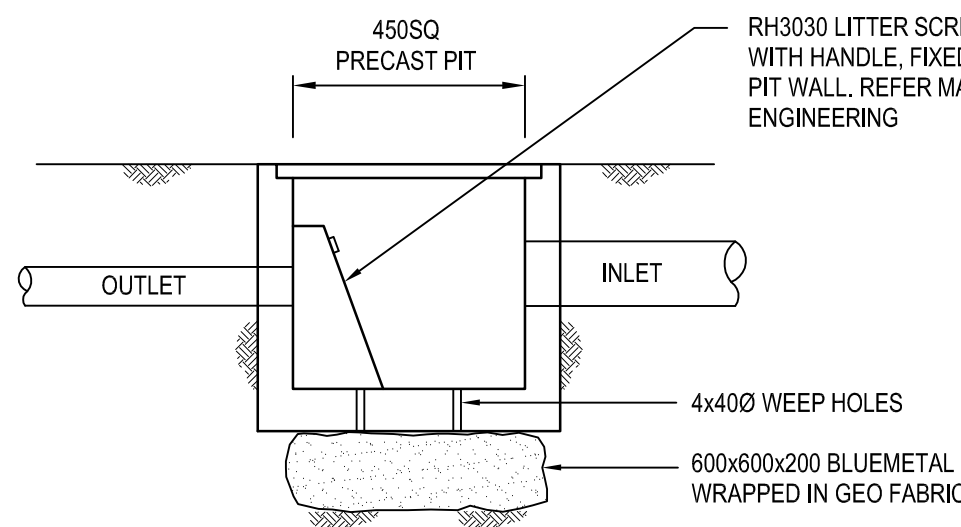

450SQ POLLUTION CONTROL PIT

1:20

A	02.11.22	REAR RETAINING DELETED
No.	DATE	REVISION DETAILS
PREPARED BY:		
 Civil & Structural Consulting Engineers ABN 55 156 273 755		
PREPARED FOR:		
Green Homes Australia		
PROPOSED RESIDENCE 3 DUNKELD AVENUE, HURLSTONE		
ORIGINAL SIZE:		A1
SCALE	1:100	DATUM: AHD
LONG SECTION	H :	CROSS SECTION H :
	V :	V :
DATE OF PLAN:	12.7.22	APPROVED
CHECKED:	C.P.M.	 Christopher P. Morris BE (Hons) MBE Aust CP Eng NRE RPEQ Accredited Engineer (No. 285027)
DRAWN	P.S.	
JOB REF:	22070-H01-A	
		SHEET 1 OF 1 SHEETS